

Linear Actuator

LAS Series

14. HIWIN LAS Series (5)

LAS5



LAS5

- LAS5
 RL = S+205
 Stroke ≤ 300
 RL = S+255
 Stroke > 300
 RL: Retracted length
 S: Stroke length

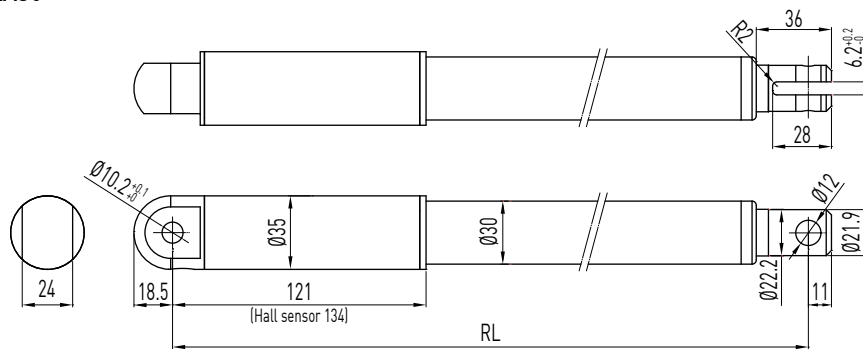

LAS5A

- LAS5A
 RL = S+240
 Stroke ≤ 300
 RL = S+290
 Stroke > 300
 RL: Retracted length
 S: Stroke length

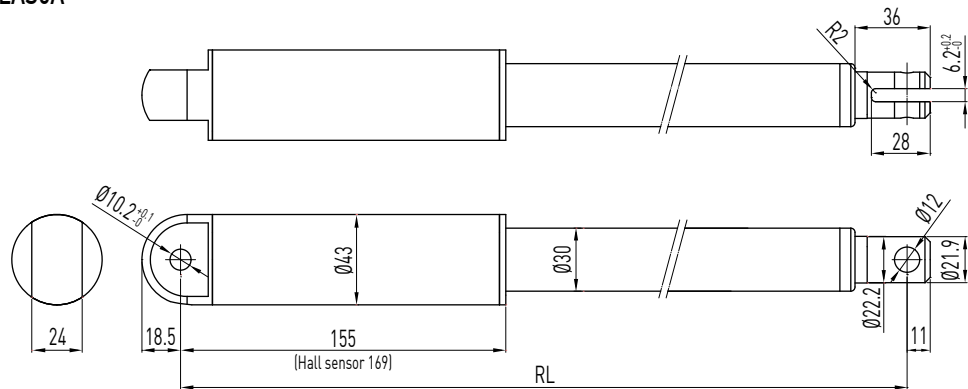

Table 14.1 Specifications

Screw type	ACME
Weight*	1.5kg
Protection	IP54
Compatible controller	LAK2/LAK2BN/LAK6B
Working temp.	+5°C~40°C

* Stroke length 100mm

Option:

- (1) Hall sensor
 [LAS5:RL = S+218, S ≤ 300/RL = S+268, S > 300;
 LAS5A:RL = S+254, S ≤ 300/RL = S+304, S > 300]
- (2) Safety nut
- (3) Reed switches
- (4) IP66
- (5) Plug: DIN 4PIN plug / Stereo plug / Mono plug

Table 14.2 LAS5 Specifications

Model	Thrust max. (N)	Pulling max. (N)	Holding max. (N)	Speed (mm / s) Load = Max. / Load = 0	Standard stroke (mm) : S					Duty cycle %	Current max. (A) 24VDC	Hall Sensor Resolution (mm/pulse)
					100	150	200	250	300			
LAS5-1	800	800	600	2.5 / 4	100	150	200	250	300	10	1	0.0084
LAS5-2	300	300	200	6 / 7.5	100	150	200	250	300	10	1	0.014

*Min. input power = Voltage x Current max.

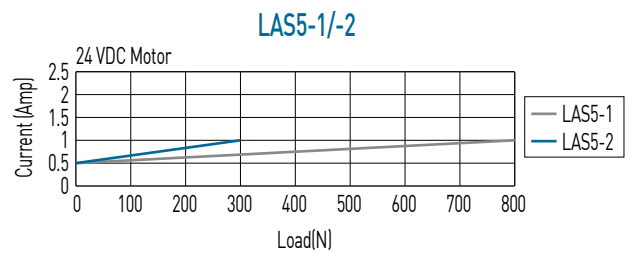
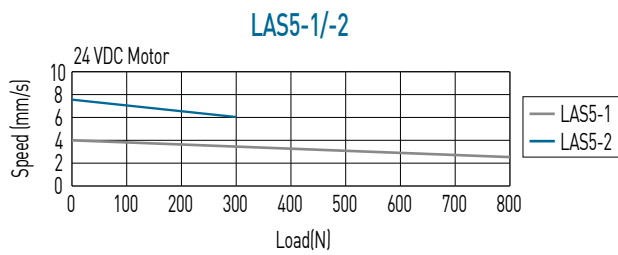

**Note: The test results are obtained by using the 24VDC power supply.

Table 14.3 LAS5A Specifications

Model	Thrust max. (N)	Pulling max. (N)	Holding max. (N)	Speed (mm / s) Load = Max. / Load = 0	Standard stroke (mm) : S					Duty cycle %	Current max. (A) 24VDC	Hall Sensor Resolution (mm/pulse)
					100	150	200	250	300			
LAS5A-1	2000	2000	1500	2.5 / 4	100	150	200	250	300	10	2.3	0.0084
LAS5A-2	1200	1200	800	7 / 8.5	100	150	200	250	300	10	2.3	0.014

*Min. input power = Voltage x Current max.

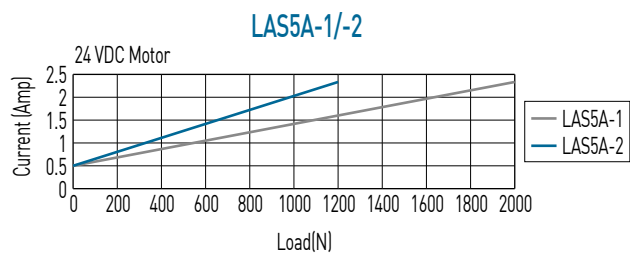
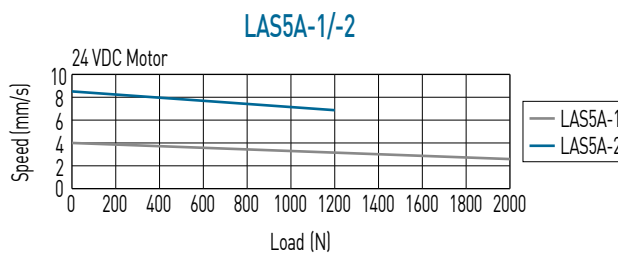

**Note: The test results are obtained by using the 24 VDC power supply.

Ordering Information

LAS5A - 1 - 0 - 200 - 24 B E					
Model number	0 : Basic model 1 : Complete with External limit switches	Stroke length	Voltage	Color B : Black	Special models according to the customer's requirement (Ignore this part of the serial number if not available)